



Project Namuna



Manavta equip's and educate's communities in rural parts of the world with the tools and resources to build low cost sanitation facilities.

Jumla, Nepal

Project launch: February 2020

Project Details

Name of School : Ashok Namuna
Primary School
Address : Bharativada, Ward-04,
Chandanath Municipality, Jumla
Date of Established : 2026 B.S (1969)
**Chairperson of School Management
Committee :** Mahendra Karki
Partner: Karnali Sports Club ([https://
karnalisports.com](https://karnalisports.com))
Total land Occupied : 4090 square

Population:

Girls: 136
Boys: 125
Out of Total Boys and Girls
Dalit Boys: 49
Dalit Girls: 35
Teacher: 6 (including one Early Child Development teacher)
Helper-1

Source of School Income:

Land in rent:
9 rooms* Rs.400= Rs.3600/month
Chamber of Commerce one room: Rs.2500/month

Why Jumla

Jumla is nestled in the mid-western region of Nepal at an altitude of 2380 m. It is a one of the most remote areas of Nepal and thus development has been a slow and expensive process. Until very recently roads have been built to this area, as previously any materials had to be flown in via helicopter or plane. We will be concentrating our efforts at Namuna Primary school.

The majority of students (80%) at this school are from the Dalit community, a highly marginalized caste in Nepal. Though the caste system has been politically “abolished,” their subjugation still remains and opportunities for students in the community are seldom. Many leave school early and end up working abroad or in Kathmandu. It is important to the development of this area that there is focus on this groups education and wellbeing.

Manavta will be the first organization to implement a WASH project at this school, and at our disposal will be local community volunteers ranging from public health, education, fine arts and government. This project will go a long way in creating not only safe sanitation but will allow this community to have a school in which their children can flourish, grow and have a decent education. The purpose goes beyond just toilets.

School Overview

For almost 15 years Namuna school had very little management, broken infrastructure and limited funding. Overtime it reached a staggering 70% drop out rate and for three years has been closed and not in use. In coordination with the local government office of Chandanath Jumla, a new management committee has been formed, teachers hired and the reconstruction of this school has started. A group of former students from Jumla Bazaar, have taken it upon themselves to help raise funds to reconstruct the school and start advocacy programs for families to enrol their kids. Since the new management committee has come together they have accomplished plenty. In the past year they have served up a team of 6 government trained teachers, which is rare at remote schools in Nepal. The school is set to open in March 2020 and currently have 91 hopeful students pre-enrolled with a capacity of 280.

What we will do

Manavta will take the role as the lead NGO in the WASH space, providing raw materials, WASH education programming and necessary training. The school and community involved will be investing the labor costs involved with this project (which equates to approx. 20% of the total project costs)

- a) Construction of a toilet structure-The toilet will be constructed using WASH sanitation guidelines, creating a gender friendly sanitation system suitable to the need's of disabled, female and male students.
- b) WASH Education - Implementation of the Manavta WASH curriculum for primary schools.
- c) Community Advocacy-Utilizing local resources in the project such as (government artists, skilled labor, youth, athletes, non profits)

Budget, Design and Estimations

Project Budget	Number	Total	Organization Responsible
Toilet Structure	5	\$6000 USD (contribution)	Manavta/Municipality of Jumla (70%/30%)
WASH Training	2 Lead Trainers	\$1000	Manavta/ENPHO support
Administrative, travel, etc	Variable	\$500	Manavta/ENPHO support

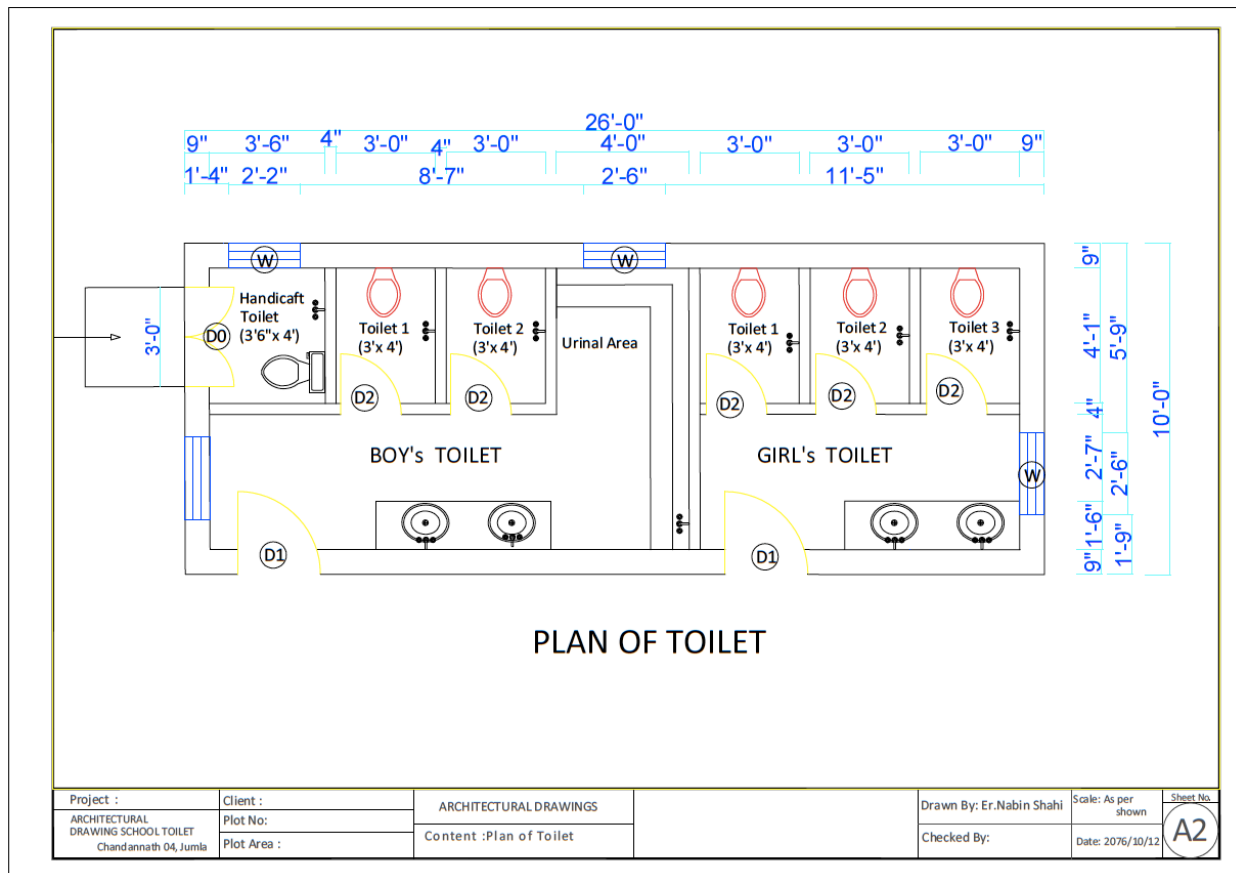

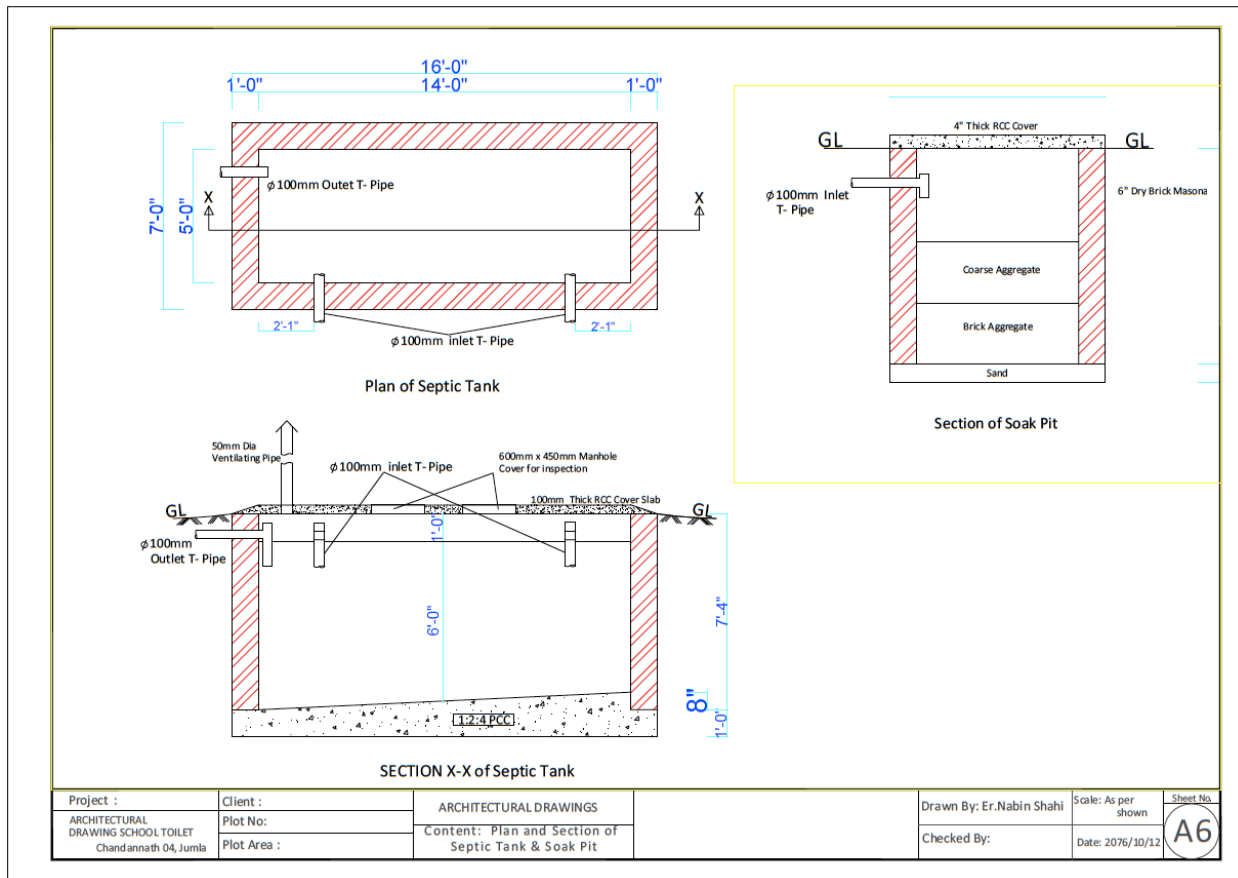

S.N	Description of Work	Quantity	Unit	Rate	Amount (NRS.)	Remarks
1	Earth work Excavation in Foundation	32.633	Cu.m	522.72	17057.9	
2	Dry Stone Masonary at Wall Foundation of Toilet	4.80	Cu.m	5780	11087.4	Stone are already available at site so 40% of items 2 and 3 are consider in total amount of cost
3	1:6 Cement Mortar 1' Thick Stone Masonary at Septic Tank	8.72	Cu.m	13770	48006.7	
4	Dry Brick Masonary at Soak Pit	0.71	Cu.m	15000	10650.0	
5	1:2:4 Plain Cement Concrete	3.40	Cu.m	18832.8	63975.2	
6	1:1.5:3 Reinforced Cement Concrete at Roof	3.70	Cu.m	23592	87353.7	
7	75 mm 1:2:4 PCC DPC with Finish at floor of Toilet room	2.94	Cu.m	1549.54	4556.9	
8	Brick Masonary with 1:4 Cement Mortar in Superstructure	14.26	Cu.m	23385	333456.5	
9	12.5mm 1:6 cement plastering work at internal side of wall	102.49	Sqm	430.1	44079.5	
10	Wooden Work for Frame	0.14	Cu.m	76621	10936.3	
11	Wooden Work for Shutter	13.60	Cu.m	7077	96251.7	
12	Low Level Cistern Ceramics 10lit Capacity	4	Nos.	2794	11176.0	
13	Toilet Pan syphon type with foot rest	5	Nos.	1180	5900.0	
14	Comode Syphon with flush (Good quality of White Hindustan)	1	Nos.	7830	7830.0	
15	Simple Brass Water Tap	8	Nos.	270.4	2163.2	
16	Hill Tank for storage of water for sanitary use	1	Nos.	10000	10000.0	
17	Reinforcement Fe 415	300	Kg	103	30900.0	
18	Other Miscellenious Work		Lumsum		20000.0	
	Total Cost				815381.03	
	Contingencies(2.5%)				20384.53	
	VAT @ 13%				105999.53	
	Grand Total Cost (NRs.)				941765.09	